

NOTE: THESE PRINTS ARE NOT FOR CONSTRUCTION.

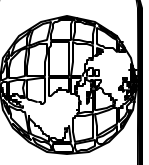
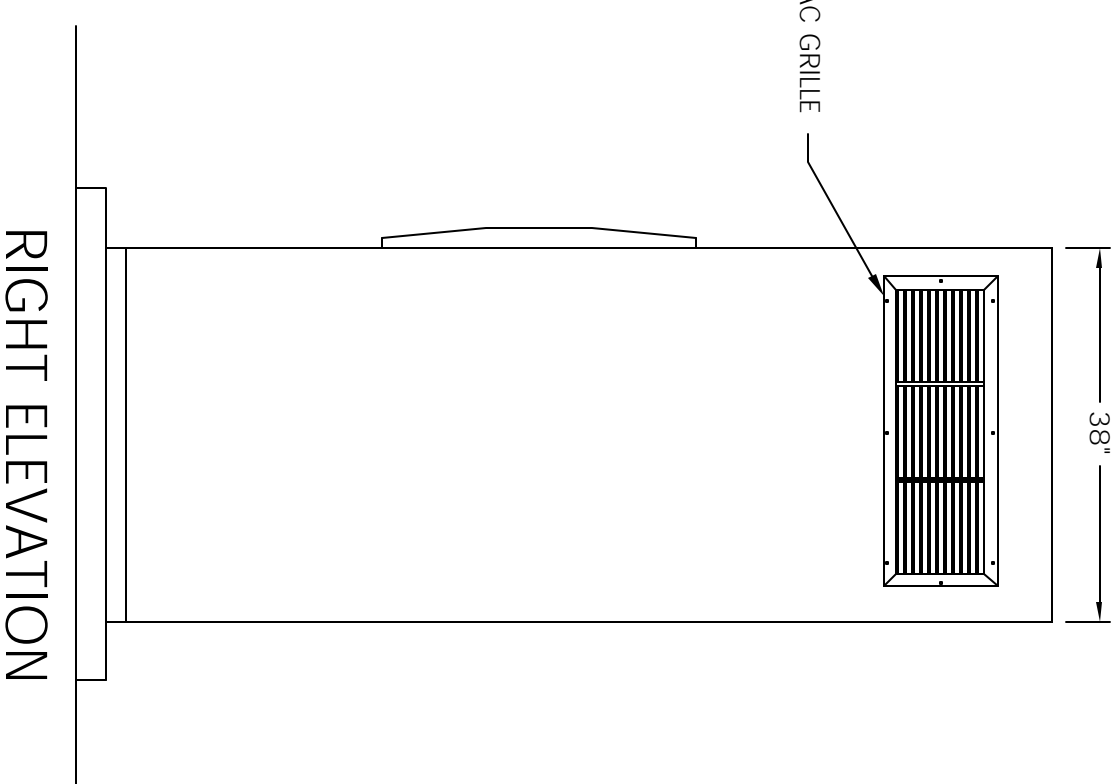
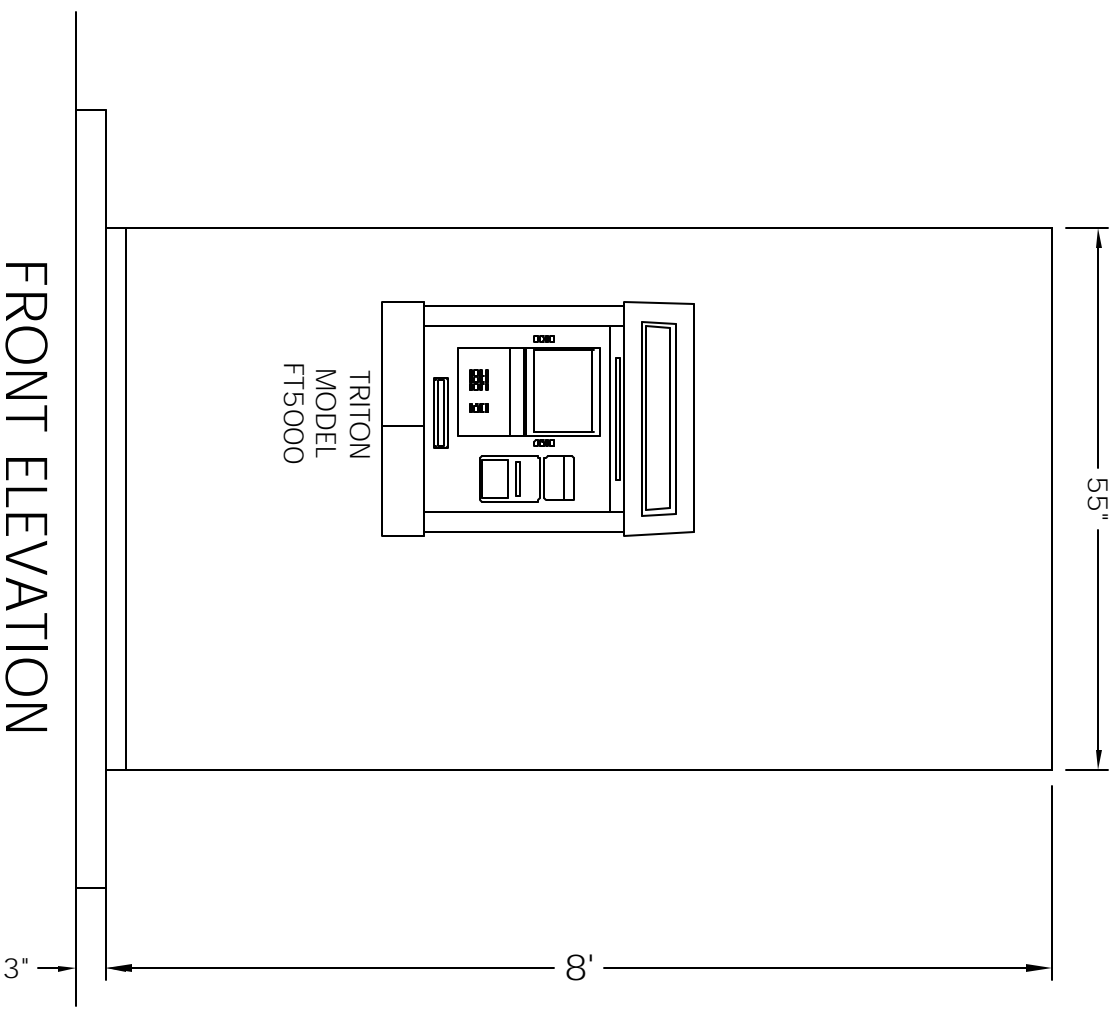

HERITAGE
The World Leader in ATM Kiosks

DEALER: ATM VENTURES
ADDRESS: 17020 SEVEN PINES DRIVE
SPRING, TX 77379

KIOSK MODEL#
936 V
ATM
TRITON FT5000

JOB# P-4274 DATE 5/23/05 DWN AH REV
DESIGNED FOR: 1ST UNITED BANK
ADDRESS:

NOTE: THESE PRINTS ARE NOT FOR CONSTRUCTION.

14GA STEEL
WALL PANELS
W/ AUTOMOTIVE
PAINT FINISH

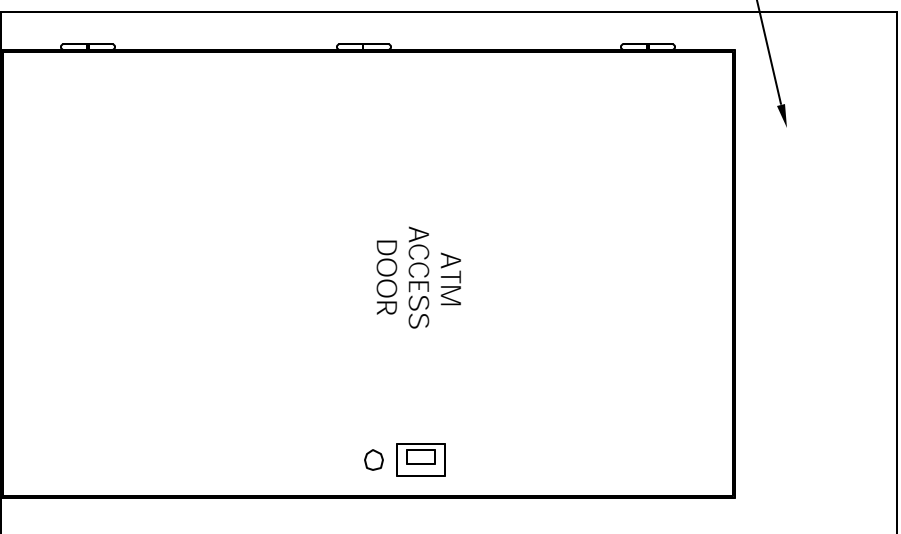

REAR ELEVATION

SCALE: 1/2" = 1'

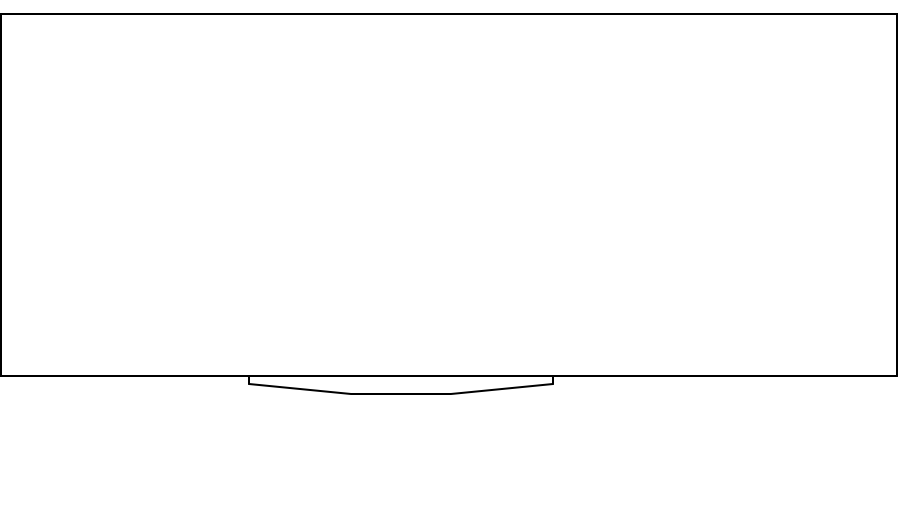

LEFT ELEVATION

SCALE: 1/2" = 1'

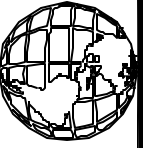

HERITAGE

The World Leader in ATM Kiosks

DEALER: ATM VENTURES
ADDRESS: 17020 SEVEN PINES DRIVE
SPRING, TX 77379

KIOSK MODEL#
936 V
ATM
TRITON FT5000

JOB# P-4274 DATE 5/23/05 DWN AH REV
DESIGNED FOR: 1ST UNITED BANK
ADDRESS:

PAGE#
2

NOTE: THESE PRINTS ARE NOT FOR CONSTRUCTION.

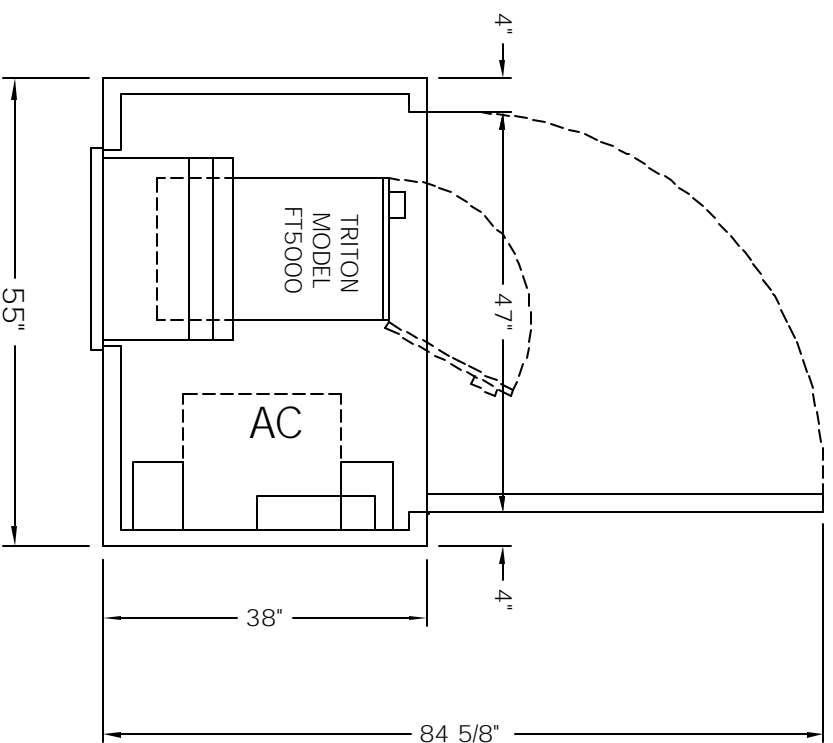

FLOOR PLAN W/ ATM IN SERVICE POSITION

ELECTRICAL NOTES:

HERITAGE INDUSTRIES HAS INSTALLED THE BUILDING ELECTRICAL SYSTEM TO THE ELECTRICAL PANEL. IT IS THE SITE CONTRACTORS' RESPONSIBILITY TO FURNISH AND INSTALL THE ELECTRICAL SERVICE AND METERING TO THE BUILDING, MAKING CONNECTIONS TO THE ELECTRICAL PANEL THROUGH THE PROVIDED RACEWAY. SITE CONTRACTOR IS RESPONSIBLE FOR BRINGING SERVICE TO THE BUILDING, AND PULLING ALL WIRES THROUGH THE PROVIDED RACEWAYS FOR PHONE, DATA AND SECURITY.

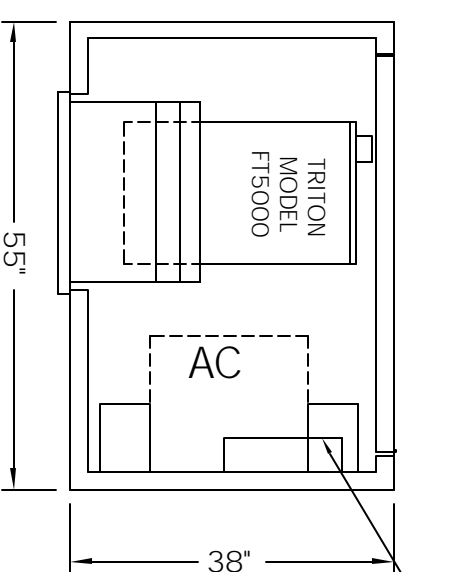

FLOOR PLAN W/ ATM IN USER POSITION

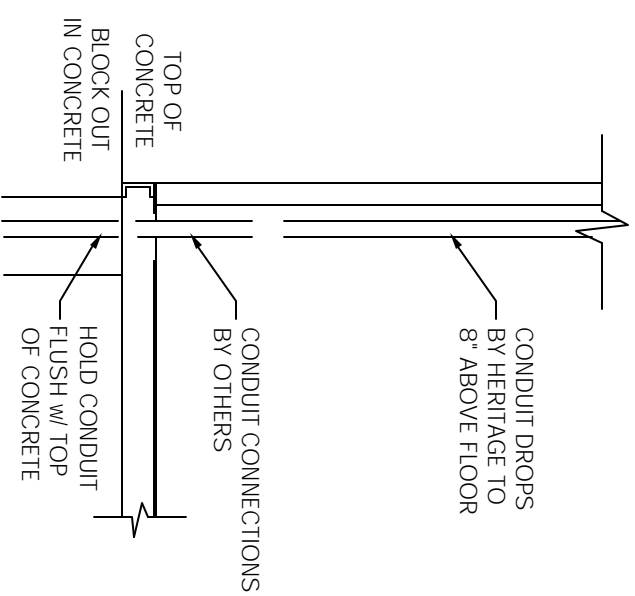

UTILITY CONNECTION DETAIL

60AMP ELECTRICAL PANEL

Panel No.	Panel Description	Panel Size	Panel Location	Panel Capacity
1	MAIN	60		20
3	DP	4	SPACE	---
5	ATM	20	DATA	20
7	SECURITY	20	HEATER	20
9	SPACE	---	SPACE	---
11	SPACE	---	SPACE	---

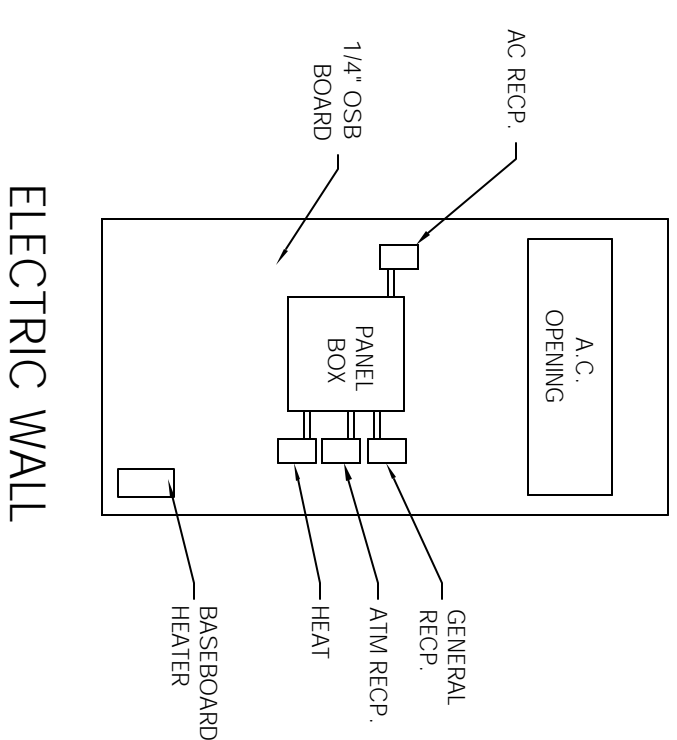

ELECTRIC WALL

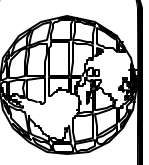

HERITAGE

The World Leader in ATM Kiosks

DEALER: ATM VENTURES
 ADDRESS: 17020 SEVEN PINES DRIVE
 SPRING, TX 77379

KIOSK MODEL# 936 V
 ATM
 TRITON FT5000

JOB# P-4274 DATE 5/23/05 DWN AH REV
 DESIGNED FOR: 1ST UNITED BANK
 ADDRESS:

